

MASTER LAYOUT PLAN OF NEHRU PHEASANTRY AT MANALI

PROJECT :
MASTER LAYOUT
PLAN OF NEHRU
PHEASANTRY AT
MANALI

CLIENT :
DIVISIONAL FOREST
OFFICER, WILD LIFE
DIVISION
KULLU H.P

LEGEND

- GATE
- WATER CHANNEL
- VISITORS PATH
- CULVERT
- ROAD (MAIN)
- SERVICE PATH
- FENCING
- BOUNDARY WALL WITH FENCING
- TICKET GHAR
- SWING
- BENCH
- SLIDE
- ELECTRIC POLE
- EXISTING ANIMAL ENCLOSURE
- PROPOSED NEW ENCLOSURE
- ENCLOSURES TO BE REDONE AFTER DEMOLISHING THE OLD STRUCTURE
- ENCLOSURES TO BE MODIFIED
- WATER BODY
- VISITOR CIRCULATION PATHWAYS
- ANIMAL HOUSE
- BUILDING
- TOILET
- WATER PIPELINE
- DRINKING WATER

SUMMARY

KALEEJ - 80 SQMT
MONAL - 80 SQMT
WESTERN TRAGOPAN - 100 SQMT
CHEER PHEASANT - 80 SQMT
KOKLAS - 80 SQMT
OFF DISPLAY ENCLOSURE (1) - 120 SQMT
OFF DISPLAY ENCLOSURE (2) - 120 SQMT
AREA OF C.B.C.SITE=0.28 HECTARE
TOTAL AREA OF THE PHEASANTRY=2 HECTARE

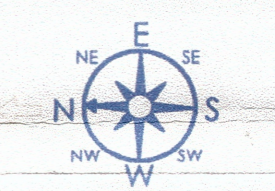

DWG. NO: M/1
 DATED: 05-07-2014
 SCALE: 1:500
 SHEET NO: 1 OF 1

studi-o-FA
architects
 G-73 TRIMURNAGAR
 M.B NEW DELHI
 110065
 STUDIOF67@GMAIL.COM

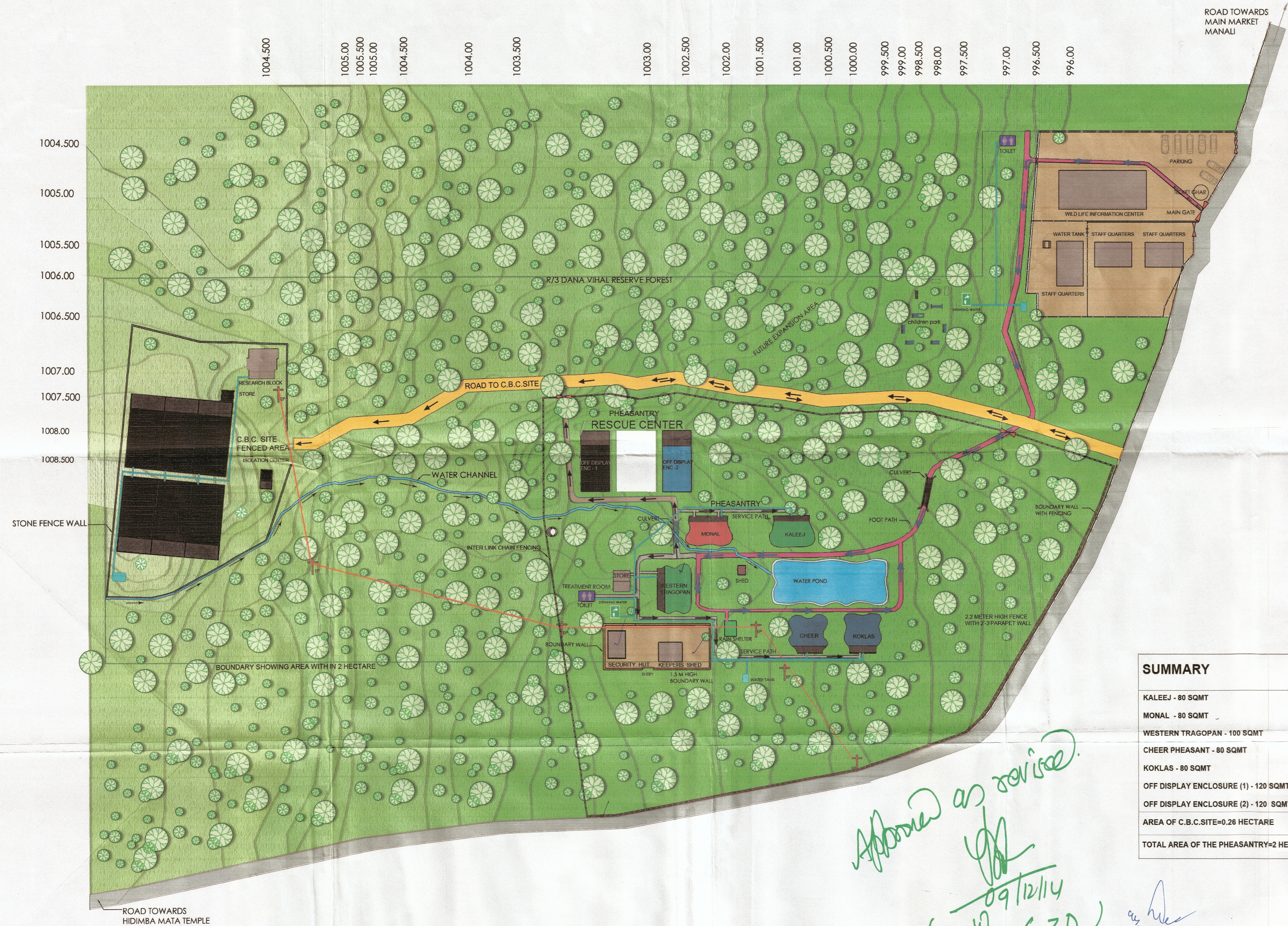

Approved as revised
 [Signature]
 09/12/14
 (Sd/- Sr. Gr. Z.D.)
 Member Secretary
 Central Zoo Authority
 (Ministry of Environment & Forests)
 Gov. of India, New Delhi

[Signature]
 P. Chief Conservator of Forests
 Himachal Pradesh Wild Life Wardens, H.P.

[Signature]
 Divisional Forest Officer
 Wild Life Division, KULLU